

## GR & EV SERIES ERV

### Installation, Operation and Maintenance Manual

GR90

EV90

EV90P

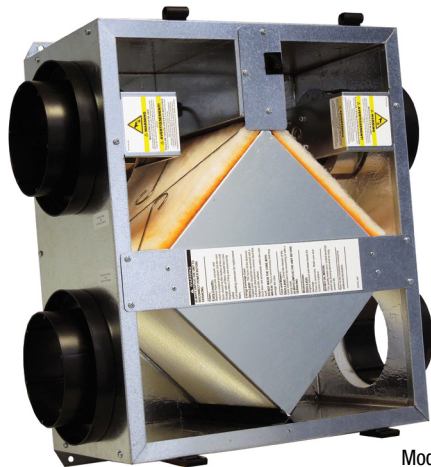

Model: GR90  
Galvanized Case  
Line Voltage  
No Line Cord

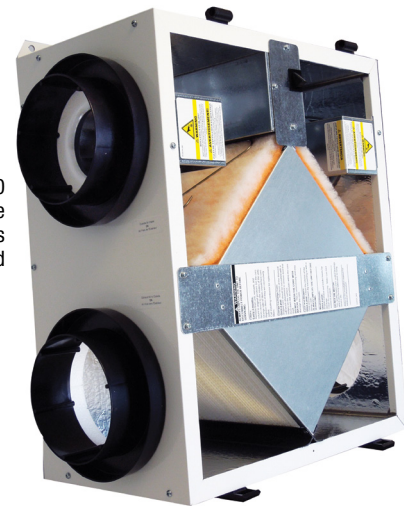

Model: EV90  
Painted Case  
Low Voltage Controls  
Line Cord

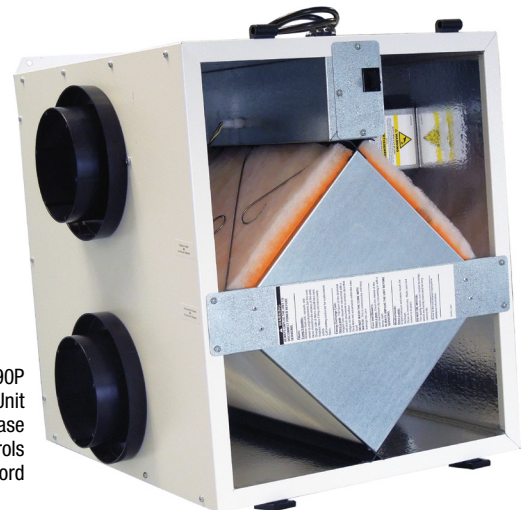

Model: EV90P  
High Performance Unit  
Painted Case  
Low Voltage Controls  
Line Cord

**⚠ WARNING**

Risk of Fire, Electric Shock, or Injury. Observe all Codes and the Following:

1. Before servicing or cleaning the unit, unplug the line cord. make sure unit is not running before opening its door.
2. This installation manual shows the suggested installation method. Additional measures may be required by local codes and standards.
3. Installation work and electrical wiring must be done by qualified professional(s) in accordance with all applicable codes, standards, and licensing requirements.
4. Any structural alterations necessary for installation must comply with all applicable building, health, and safety code requirements.
5. Connect this unit only to a 120 VAC grounded receptacle protected by a 15 or 20 amp circuit breaker. Do not remove the unit's line cord.
6. Do not install unit or controls where they can be reached from a tub or shower.
7. This unit must be properly ducted to the outdoors.
8. Outside air inlet for this unit must be located away from sources of hazardous air such as auto exhausts.
9. Sufficient air is needed for proper combustion and exhausting of gases through the flue (chimney) of fuel burning equipment that might be installed in the area affected by this equipment. If this unit is exhausting air from a space in which chimney-vented fuel burning equipment is located, take steps to assure that combustion air supply is not affected. Follow the heating equipment manufacturer's requirements of applicable codes and standards.
10. This unit is intended for general ventilating only. Do not use to exhaust hazardous or explosive materials and vapors. Do not connect this unit to range hoods, fume hoods, or collection systems for toxics.
11. When cutting or drilling into wall or ceiling, do not damage electrical wiring and other hidden utilities.
12. Use the unit only in the manner intended by the manufacturer. If you have questions, contact the manufacturer.

**⚠ WARNING**

There is no known safe level of cigarette smoke. Any ventilation system may provide noticeable improvement in spaces where cigarettes are smoked, but it cannot be expected to protect against the severe long-term health hazards of exposure to cigarette smoke.

**⚠ CAUTION**

1. To avoid motor bearing damage and noise and/or unbalanced mpellers, keep drywall spray, construction dust, etc., out of unit.
2. Do not connect power to the units external control terminals: this will damage the unit. The external terminals are for use only with unpowered controls designed for low-voltage operation.

**⚠ CAUTION**

Provide Adequate Service Access for Maintenance

The unit will require regular filter and core inspections. Install the unit where you can access the core for cleaning and replacing the filters, and where you can get at the wiring for installation and service.

**⚠ CAUTION**

Do not remove or disable the wiring interconnection between the Overload Relays and the Contactors. Without this inter-connection the motor(s) will not be protected against overload.

**⚠ CAUTION**

DO NOT WASH THE ENERGY EXCHANGE CORE.

Keep it away from water or fire to avoid damaging it. Always handle the core carefully.

## SAVE THIS MANUAL

## NOTICE

Information that is recorded is specific to just one ERV. If additional ERVs are being documented, please make copies of these pages and identify each copy by its unit tag.

## UNIT INFORMATION

Record information as shown below. In the unlikely event that factory assistance is ever required, this information will be needed.

Locate the RenewAire unit label, to be found outside of the appliance. Record the model and serial numbers below.

NOTE: This information is for purposes of identifying the specific air handling appliance. Unit-specific option data can then be obtained, as needed, from the Model Number.

ERV Model:

☐

GR90

☐

EV90

☐

EV90P

Serial Number:



NOTE: This page is to be completed by the installing contractor. The completed document is to be turned over to the owner after start-up.

UNIT INFORMATION

			
Energy Recovery Ventilation		DUCTED HEAT RECOVERY VENTILATOR	
MODEL	EV90	MODELE	89S5
<b>⚠ WARNING ⚠ AVERTISSEMENT</b>			
Danger of electrical shock. Always disconnect from power source before servicing.		Danger de choc électrique. Toujours déconnecter la source d'alimentation avant les réparations.	
Line cord provided with unit may be removed for permanent power supply connection. Cordon fourni avec l'unité peut être enlevé pour une connexion d'alimentation permanente.			
For Permanently Connected Units: Use Copper Conductors Only. Pour les appareils connectés en permanence: Utiliser cuivre conducteurs uniquement.			
120V, 60HZ, 1 Phase		120V, 60HZ, 1 Phase	
Unit	MCA: 10	MFS: 15	Unit
Motor: Qty (2) @ 0.03 HP & 0.16 F.L.A.		Moteur: Qty (2) @ 0.03 CV & 0.16 A.P.C.	
Motors Thermally Protected		Moteurs protégés thermiquement	
Do not install in a cooking area or make line-voltage electrical power connections directly between this unit and any appliance. N'installez pas de zone de cuisine ou de ligne de tension les connexions d'alimentation électrique directement entre cette unité et tout.			
		CERTIFIED RATINGS Model EV90 Rated Air Flow @ 0.2 in wg (50Pa) 98 cfm (46 L/s) 0.4 in wg (100Pa) 73 cfm (34 L/s)	
Energy Performance		Complete ratings at: <a href="http://www.hvi.org">www.hvi.org</a>	
Net Supply Air Flow	Apparent Sensible Effectiveness	Sensible Recovery Efficiency	Moisture Transfer
90 cfm (43 L/s) at 32°F (0°C)	79%	72%	37%
90 cfm (43 L/s) at 95°F (35°C)	46% Total Recovery Efficiency		
Part NO.: 102700_000		RenewAire, LLC	
Serial Number: D156029R		4510 Helgesen Drive	
		Madison, WI 53718	

UNIT LABEL (TYPICAL)



INDOOR UNIT

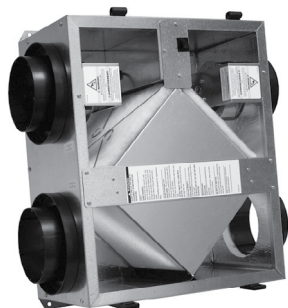

Download specification at:  
[renewaire.com/specifications](http://renewaire.com/specifications)

## Energy Recovery Ventilator Standard



### SPECIFICATIONS

#### Ventilation Type:

Static plate, heat and humidity transfer

**Typical Airflow Range:** 40-110 CFM

**Unit is HVI Tested/Certified per CSA C439**

**Protocol:** Using one L-35 G5 Core

#### Standard Features:

Galvanized cabinet  
 Terminal strip hard wiring in ebox (no line cord)  
 Unit may be mounted in any orientation  
 Cross-core differential pressure ports

#### Control:

Can use any switched line-voltage power supply  
 (no low-voltage controls)

#### Filters:

Total qty. 2, MERV 8, spun-polyester media:  
 9 5/8" x 10 1/2" x 1"

#### Unit Dimensions: & Weight

22 1/2" L x 11 3/4" W x 23 3/4" H  
 36 lbs.

#### Max. Shipping Dimensions & Weight (in carton):

29" L x 22" W x 15" H  
 40 lbs.

#### Motor(s):

Qty. 2, Standard motorized impeller blowers

#### Accessories:

Backdraft damper 6", 8"  
 Automatic balancing damper 4", 5", 6"  
 Louvered wall vent 6" - white, brown  
 120V line voltage Honeywell control  
 MERV 13 filter - OA airstream  
 Electric duct heater - RH series (1-11.5 kW);  
 designed for indoor ductwork installation only

**Note:** Indirect Gas-Fired Duct Furnace is not available on the GR90.

### ELECTRICAL DATA

HP	Volts	HZ	Phase	Input Watts	FLA
0.03	120	60	Single	46 @ 90 CFM	0.35

### UNIT PERFORMANCE

Airflow CFM	ESP in H <sub>2</sub> O
36	0.60
52	0.50
67	0.40
81	0.30
94	0.20
108	0.10

### CORE PERFORMANCE

Airflow CFM	Temp EFF%	Total EFF% Winter/Summer*
36	78	75/65
52	74	69/58
67	70	65/53
81	67	61/49
94	64	58/45
108	61	55/42

**Note:** These are core-only ratings and are not HVI certified.

HVI ratings apply to complete units only.

See HVI certification ratings on pg. 24 of Single/Multi-Family Catalog.

### UNIT DIMENSIONS



#### AIRFLOW ORIENTATION

Available as shown in dimension drawing.



#### UNIT MOUNTING & APPLICATION

Can be mounted in any orientation. RA/EA airstream  
 can be switched with OA/FA airstream.

#### ABBREVIATIONS

EA: Exhaust Air to outside  
 OA: Outside Air intake  
 RA: Room Air to be exhausted  
 FA: Fresh Air to inside

#### INSTALLATION ORIENTATION

Unit may be installed in any  
 orientation.

#### NOTE

1. UNLESS OTHERWISE SPECIFIED,  
 DIMENSIONS ARE ROUNDED TO THE  
 NEAREST EIGHTH OF AN INCH.

2. SPECIFICATIONS MAY BE SUBJECT  
 TO CHANGE WITHOUT NOTICE.

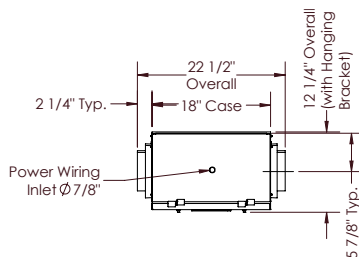

TOP VIEW

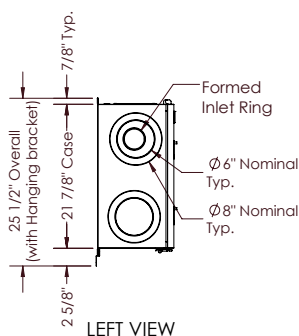

LEFT VIEW

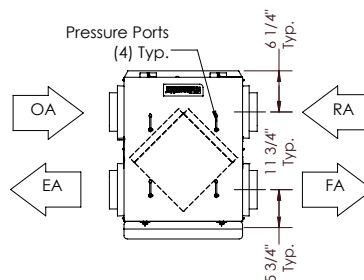

FRONT VIEW

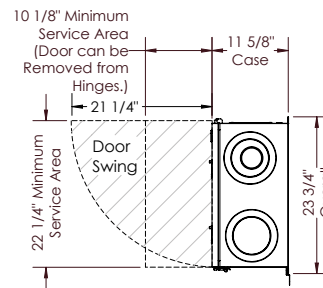

RIGHT VIEW

Specifications may be subject to change without notice.



Download specification at:  
[renewaire.com/specifications](http://renewaire.com/specifications)

## SPECIFICATIONS

### Ventilation Type:

Static plate, heat and humidity transfer

**Typical Airflow Range:** 40-110 CFM

**Unit is HVI Tested/Certified per CSA C439**

**Protocol:** Using one L-35 G5 Core

### Standard Features:

White painted cabinet  
Line-cord power supply  
Low-voltage circuit for controls  
Unit may be mounted in any orientation  
Cross-core differential pressure ports

### Control:

Onboard 24 VAC transformer/relay package  
with switched dry contacts

### Filters:

Total qty. 2, MERV 8, spun-polyester media:  
9 5/8" x 10 1/2" x 1"

### Unit Dimensions & Weight:

22 1/2" L x 11 3/4" W x 23 3/4" H  
36 lbs.

### Max. Shipping Dimensions & Weight (in carton):

29" L x 22" W x 15" H  
40 lbs.

### Motor(s):

Qty. 2, Standard motorized impeller blowers

### Accessories:

Backdraft damper 6", 8"  
Automatic balancing damper 4", 5", 6"  
Louvered wall vent 6" - white, brown  
Carbon dioxide sensor/control - wall mount (CO2-W)  
IAQ sensor - wall mount (IAQ-W)  
Motion occupancy sensor/control -  
ceiling mount (MC-C), wall mount (MC-W)  
Percentage timer control (PTL)  
Push-button point-of-use controls (PBL), PTL req'd.  
Percentage timer control with furnace interlock (FM)  
MERV 13 filter - OA airstream  
Electric duct heater - RH series (1-11.5 kW);  
designed for indoor ductwork installation only

**Note:** Indirect Gas-Fired Duct Furnace is not available on the EV90.

## ELECTRICAL DATA

HP	Volts	HZ	Phase	Input Watts	FLA
0.03	120	60	Single	46 @ 90 CFM	0.35

## UNIT PERFORMANCE

Airflow CFM	ESP in H <sub>2</sub> O
36	0.60
52	0.50
67	0.40
81	0.30
94	0.20
108	0.10

## CORE PERFORMANCE

Airflow CFM	Temp EFF%	Total EFF% Winter/Summer*
36	78	75/65
52	74	69/58
67	70	65/53
81	67	61/49
94	64	58/45
108	61	55/42

**Note:** These are core-only ratings and are not HVI certified.

HVI ratings apply to complete units only.

See HVI certification ratings on pg. 24 of Single/Multi-Family Catalog.

## UNIT DIMENSIONS



### AIRFLOW ORIENTATION

Available as shown in dimension drawing.



### UNIT MOUNTING & APPLICATION

Can be mounted in any orientation. RA/EA airstream  
can be switched with OA/FA airstream.

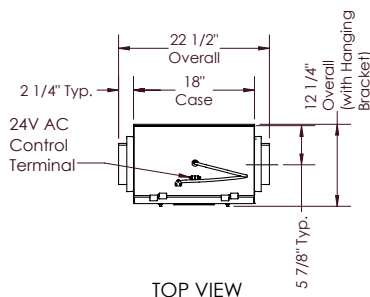

### ABBREVIATIONS

EA: Exhaust Air to outside  
OA: Outside Air intake  
RA: Room Air to be exhausted  
FA: Fresh Air to inside

### INSTALLATION ORIENTATION

Unit may be installed in any orientation.

### NOTE

1. UNLESS OTHERWISE SPECIFIED, DIMENSIONS ARE ROUNDED TO THE NEAREST EIGHTH OF AN INCH.

2. SPECIFICATIONS MAY BE SUBJECT TO CHANGE WITHOUT NOTICE.

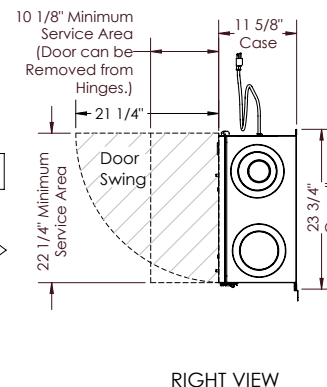
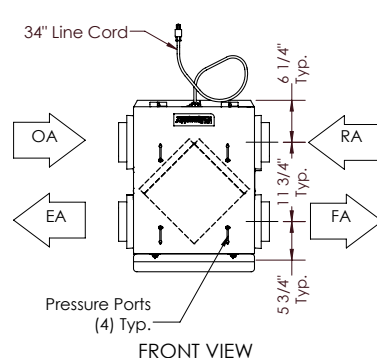
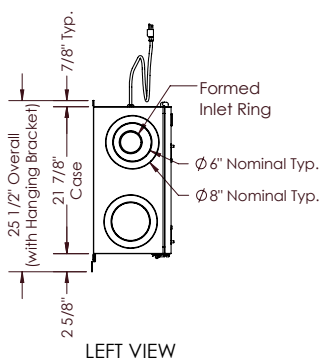

Specifications may be subject to change without notice.

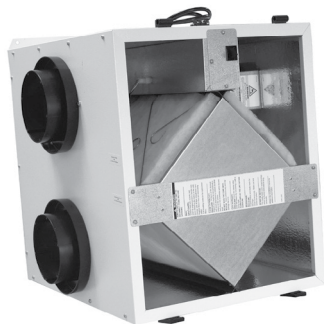

Download specification at:  
[renewaire.com/specifications](http://renewaire.com/specifications)

### SPECIFICATIONS

#### Ventilation Type:

Static plate, heat and humidity transfer

**Typical Airflow Range:** 40-110 CFM

**Unit is HVI Tested/Certified per CSA C439 Protocol:** Using one L-100 G5 Core

#### Standard Features:

White painted cabinet  
Line-cord power supply  
Low-voltage circuit for controls  
Unit may be mounted in any orientation  
Cross-core differential pressure ports

#### Controls:

Onboard 24 VAC transformer/relay package  
with switched dry contacts

#### Filters:

Total qty. 2, MERV 8, spun-polyester media:  
21 3/4" x 10 1/2" x 1"

#### Unit Dimensions & Weight:

22 1/2" L x 24" W x 23 3/4" H  
51 lbs.

#### Max. Shipping Dimensions & Weight (in carton):

33" L x 22" W x 29" H  
65 lbs.

#### Motor(s):

Qty. 2, Standard motorized impeller blowers

#### Accessories:

Backdraft damper 6", 8"  
Automatic balancing damper 4", 5", 6"  
Louvered wall vent 6" - white, brown  
Carbon dioxide sensor/control - wall mount (CO2-W)  
IAQ sensor - wall mount (IAQ-W)  
Motion occupancy sensor/control -  
ceiling mount (MC-C), wall mount (MC-W)  
Percentage timer control (PTL)  
Push-button point-of-use controls (PBL), PTL req'd.  
Percentage timer control with furnace interlock (FM)  
MERV 13 filter - OA airstream  
Electric duct heater - RH series (1-11.5 kW);  
designed for indoor ductwork installation only

**Note:** Indirect Gas-Fired Duct Furnace is not available on the EV90P.

### ELECTRICAL DATA

HP	Volts	HZ	Phase	Input Watts	FLA
0.03	120	60	Single	44 @ 90 CFM	0.35

### UNIT PERFORMANCE

Airflow CFM	ESP in H <sub>2</sub> O
42	0.60
56	0.50
73	0.40
87	0.30
99	0.20
108	0.10

### CORE PERFORMANCE

Airflow CFM	Temp EFF%	Total EFF% Winter/Summer*
42	86	83/71
56	85	82/70
73	84	80/68
87	83	79/67
99	82	78/66
108	82	78/65

**Note:** These are core-only ratings and are not HVI certified.

HVI ratings apply to complete units only.

See HVI certification ratings on pg. 24 of Single/Multi-Family Catalog.

### UNIT DIMENSIONS



#### AIRFLOW ORIENTATION

Available as shown in dimension drawing.



#### UNIT MOUNTING & APPLICATION

Can be mounted in any orientation. RA/OA airstream  
can be switched with OA/FA airstream.

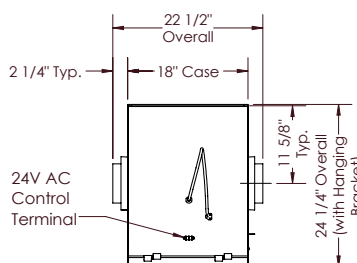

TOP VIEW

#### ABBREVIATIONS

EA: Exhaust Air to outside  
OA: Outside Air intake  
RA: Room Air to be exhausted  
FA: Fresh Air to inside

#### INSTALLATION ORIENTATION

Unit may be installed in any orientation.

#### NOTE

1. UNLESS OTHERWISE SPECIFIED, DIMENSIONS ARE ROUNDED TO THE NEAREST EIGHTH OF AN INCH.

2. SPECIFICATIONS MAY BE SUBJECT TO CHANGE WITHOUT NOTICE.

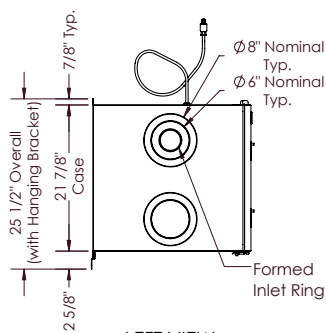

LEFT VIEW

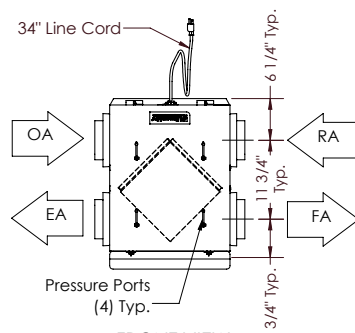

FRONT VIEW

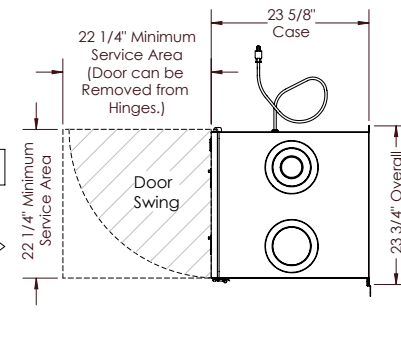

RIGHT VIEW

Specifications may be subject to change without notice.

<b>1.0 OVERVIEW</b>	<b>9</b>
1.1 DEFINITIONS .....	9
1.2 DESCRIPTION .....	9
1.2.1 Purpose of an ERV System .....	9
1.2.2 When Should You Use Your ERV.....	9
1.2.3 Using an ERV with Air-Conditioning .....	9
1.2.4 Controlling Excess Humidity During Cold Weather .....	9
<b>2.0 UNIT PLACEMENT</b>	<b>9</b>
2.1 BEFORE YOU BEGIN .....	9
2.2 LOCATION OF THE UNIT .....	10
2.3 DUCT SIZES AND INSULATION.....	10
2.3.1 Duct Sizes .....	10
2.4 DUCTWORK APPLICATIONS .....	11
<b>3.0 INSTALLATION</b>	<b>13</b>
3.1 MOUNTING THE UNIT .....	13
3.2 INSTALLING OUTSIDE AIR AND EXHAUST AIR DUCTS .....	14
3.3 INSIDE DUCTWORK SYSTEM (FOR WALL MOUNTED UNITS ONLY).....	14
3.4 INSTALLING RETURN AIR DUCTS .....	14
3.5 CONTROLS .....	15
3.5.1 Installing Controls.....	15
<b>4.0 OPERATION</b>	<b>16</b>
4.1 STARTING UP THE UNIT .....	16
4.2 VERIFYING UNIT PERFORMANCE .....	16
4.2.1 Airflow .....	16
4.2.2 Use Static Taps to Measure Airflow Rates .....	16
4.2.3 Use Damper to Balance Airflow to Desired Rates .....	16
4.3 MEASURING AIRFLOW .....	17
4.4 MEASURING CROSS CORE STATIC PRESSURE .....	17
<b>5.0 MAINTENANCE</b>	<b>18</b>
5.1 TO CLEAN THE ENERGY EXCHANGE ELEMENT .....	18
5.2 INSPECT AND CHANGE THE FILTERS REGULARLY.....	18
5.3 MOTOR MAINTENANCE .....	19
5.4 GENERAL CLEANING AND INSPECTION .....	19
5.5 SERVICE PARTS.....	19
<b>6.0 FACTORY ASSISTANCE</b>	<b>19</b>

**TABLE OF ILLUSTRATIONS**

Figure 2.2.0 Service Clearances .....	10
Figure 2.4.0 Separate Room Air Pick-up—Fresh Air to Furnace Return Air Trunkline .....	12
Figure 2.4.1 Separate Return Air and Fresh Air Supply .....	12
Figure 2.4.2 Funace Return Air back into Return Air .....	12
Figure 2.4.3 RFurnace Return Air back into Supply Air, EV90/P only .....	12
Figure 3.1.0 Mounting the ERV to a Stud Wall, EV90/P only .....	13
Figure 3.5.0 Typical Control Schematic, EV90/P only .....	15
Figure 4.2.0 Damper Installation .....	16
Figure 4.4.0 Airflow Diagram EV90/P .....	17
Figure 5.5.0 Service Parts, EV90/P .....	19

## 1.0 OVERVIEW

### 1.1 DEFINITIONS

#### Energy Exchange System:

Cross flow fixed-plate enthalpic energy exchange core: engineered, proprietary resin-media composite. Moderates both temperature and humidity extremes.

#### Access Door:

Front panel opens to provide access to filters, blowers, and energy exchanger. Snap latches and hinges provided for easy service.

#### Insulation:

1" foil-faced EPS foam throughout.

#### Blower/Motor:

Two high efficiency motorized impeller blowers provide quiet operation.

#### Warranty:

Ten year limited warranty on energy exchange core; five year limited warranty against defects in material and workmanship on all other components.



**NOTE:** This unit is an Energy Recovery Ventilator, or ERV. It is commonly referred to throughout this manual as an ERV.

### 1.2 DESCRIPTION

#### 1.2.1 Purpose of an ERV System

Many modern homes are built air-tight for energy efficiency and comfort. The result is that natural air infiltration rates are often too low to provide acceptable indoor air quality. The solution is to use an ERV to remove gaseous pollutants such as odors, winter-time excess humidity, formaldehyde, smoke, radon, vapors from cleaning products, and other chemicals. The removal of dust and other small particles from your home is not the function of an ERV.

#### 1.2.2 When Should You Use Your ERV?

Use your ERV when windows are closed and you need to ventilate. When the outdoor air is warmer or cooler than comfortable, the ERV will allow a quieter, more secure home with the windows closed and will also save energy.

#### 1.2.3 Using an ERV with Air-Conditioning

An ERV works very well with air-conditioning, because its “enthalpy-transfer” energy-exchange core will reduce the amount of moisture in the outside air that is brought in. ERVs are the preferred way to ventilate while air-conditioning because it brings in less moisture than any other ventilation method.

#### 1.2.4 Controlling Excess Humidity During Cold Weather

When the ERV is first turned on at the beginning of the heating season (or when first installed), it will have to run full-time for several days to reduce indoor humidity levels. A properly set dehumidistat will do this automatically. If your control is the proportional timer type (PTL or FM), it should be set to “100%” for several days whenever you have a problem with excess humidity during cold weather.

## 2.0 UNIT PLACEMENT

### 2.1 BEFORE YOU BEGIN

Read all instructions before installing the unit. Also review supplemental instructions included with any controls that will be installed. Carefully unpack and inspect the unit for shipping damage. Open the access door and inspect inside the unit. Attach the four duct collars to the unit with the screws provided in the plastic small-parts bag.

## 2.2 LOCATION OF THE UNIT

Select a location so that:

- The fresh air intake vent from the outside is placed a minimum of ten feet from any other contaminated exhaust vent, and is at least 30" long.
- The two ducts to the outside are as short and straight as possible, for the best performance from the system. Shorter duct runs help assure that the system is balanced: the amount of air brought in is equal to the amount of air exhausted.
- The door can be opened to allow cleaning the core and filters. Provide clearance at front of unit for service access to the blowers, filters, and energy exchange core. (24" minimum.)
- The exhaust outlet and fresh air inlet on the outside of the building should be at least 10' apart to avoid cross-contamination. The exhaust duct should be about the same length as the fresh air duct.
- The exhaust outlet should not dump air into an enclosed space or into any other structure.
- Do not install the exhaust outlet and fresh air inlet through the roof. If these are the only available options call RenewAire technical support for help.

The preferred mounting location for the unit is on a concrete foundation wall because the foundation wall will isolate any blower vibration.

If a basement area is not available or practical, use other mechanical room space such as a closet, garage, storage, or accessible attic or crawl space.

**NOTE:** If you wish to install the unit in an attic or other unconditioned space, you may need to use special installation techniques such as insulating all connecting ductwork. Attic installations are allowed for residential applications only.

### CAUTION

**Provide Adequate Service Access for Maintenance**

The unit will require regular filter and core inspections. Install the unit where you can access the core for cleaning and replacing the filters, and where you can get at the wiring for installation and service.

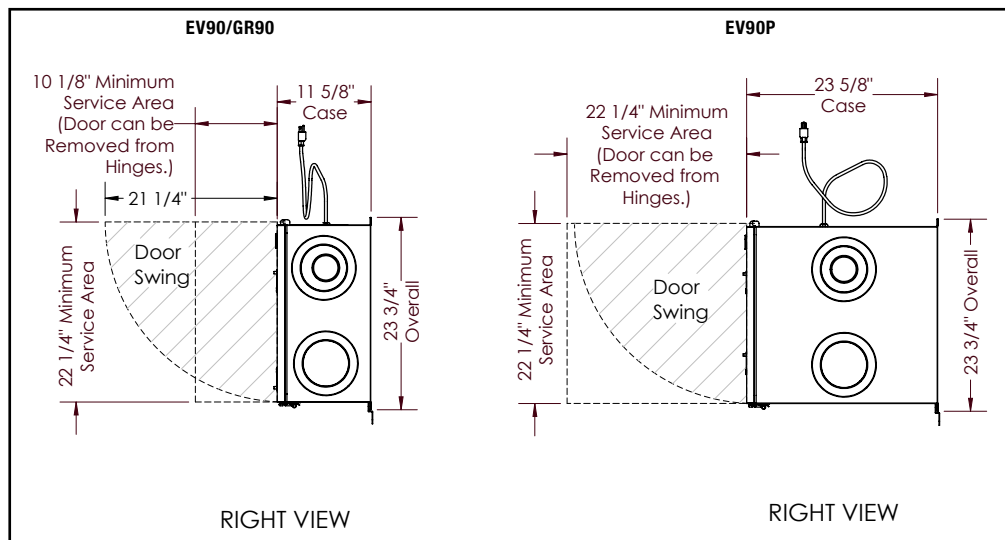

FIGURE 2.2.0 SERVICE CLEARANCES

## 2.3 DUCT SIZES AND INSULATION

The Exhaust Air Duct and the Outside Air Duct connect the unit to the outside. Flexible insulated duct is typically used.

### 2.3.1 Duct Sizes

Exhaust Air & Outside Air (EA & OA):

- 6" round insulated duct, 8" round insulated duct may be used to maintain maximum airflow.

Fresh Air & Return Air (FA & RA):

- 6" round or 8" oval rigid un-insulated.

All ducts from unit to house in unconditioned spaces like attics and crawl spaces must be insulated.

## 2.4 DUCTWORK APPLICATIONS

### • FOR HOUSES WITHOUT DUCTED HEATING OR COOLING SYSTEMS—SEE FIGURE 2.4.1.

In most houses one or two fresh air grilles in a central part of the house provide effective distribution of the fresh air into the home, particularly when the stale exhaust air is picked up at several points. Because the fresh air is not fully conditioned, the fresh air supply grilles should be located in a traffic area like a hallway or stairway rather than in a sitting area. If you want to get fresh air into specific rooms with high occupancy, you can split up the fresh air supply.

### • FOR HOUSES WITHOUT DUCTED HEATING OR COOLING SYSTEMS—SEE FIGURES 2.4.0, 2.4.2, AND 2.4.3.

Most units are installed with the fresh air duct connected directly to a return duct for the main heating and cooling system. Be careful to connect the fresh air duct at least three feet from the return plenum to minimize suction from the furnace blower. A connection closer to the furnace may result in unbalanced flow and associated problems.

### • FOR INSTALLATIONS THAT COLLECT STALE AIR FROM SPECIFIC ROOMS IN THE HOME—SEE FIGURES 2.4.0 AND 2.4.1.

Locate stale air return grilles (RA) in rooms where moisture and odors are generated: bathrooms, the kitchen, and perhaps other areas where contaminants are generated such as in the home workshop. Return grilles in these other areas may be dampered so that they can be shut off when not in use. A central location such as a hallway is also acceptable but won't clear humidity and odors from baths and kitchens as rapidly. Locate stale air return grilles (RA) near the ceiling on inside walls. Stale air returns are usually easiest to install in interior partitions.

### • STALE AIR RETURN GRILLE SIZES

- **BATHROOM:** 4" x 10" or 6" x 10"—40 to 60 sq. in.
- **KITCHEN:** 6" x 10"—60 sq. in.

### • CAN AN ERV BE USED TO VENTILATE BATHROOMS?

A RenewAire ERV can be used as a central exhaust system in place of bathroom exhaust fans. Tie a grille in each bathroom directly back to the ERV—see Figure 2.4.0. A successful installation should provide at least 50 CFM of exhaust per moisture producing bathroom. When used for bathroom exhaust, the EV90/P should be used for only one bathroom. Install a control in the bathroom ventilated by the ERV.

### • FOR HOUSES WHERE RADON IS A CONCERN.

The first line of defense against radon should always be techniques that prevent the entry of radon into the home, such as under-slab suction, vented perimeter drainage, and crack sealing. However, if moderate levels of radon continue to be present, it is important that the unit slightly pressurize the basement, not de-pressurize the basement. Installation of this unit for radon mitigation is beyond the scope of this manual. Consult a radon mitigation professional.

See Figures 2.4.0 through 2.4.3 for examples of some common installation approaches.



**NOTE:** For all units:  
RA = Room Air into unit

OA = Outside Air into unit  
SA = Supply Air to inside  
EA = Exhaust Air to outside  
FA = Fresh Air to inside



NOTE: ERV blower may be operated separate from furnace blower.

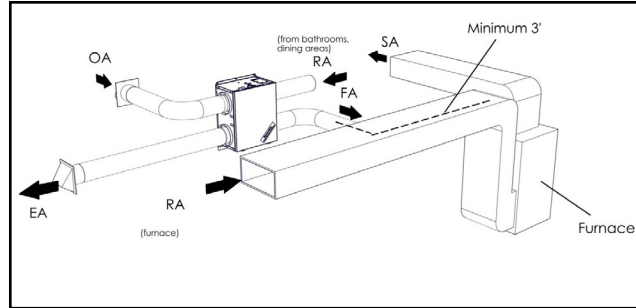

FIGURE 2.4.0 SEPARATE ROOM AIR PICK-UP—FRESH AIR TO FURNACE RETURN AIR TRUNKLINE



NOTE: ERV blower may be operated separate from furnace blower.

\*Use caution to introduce FA at low velocity and where good mixing will occur to minimize discomfort from drafts

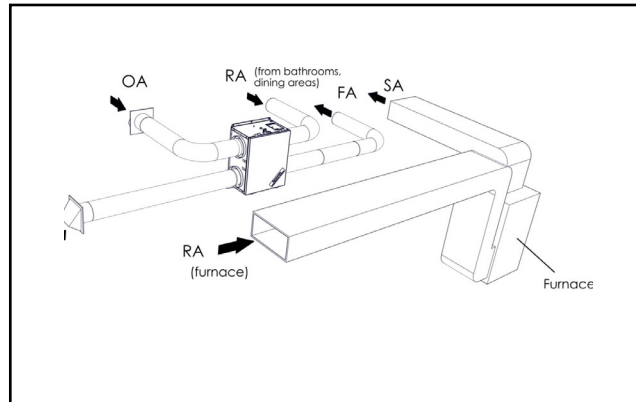

FIGURE 2.4.1 SEPARATE RETURN AIR AND FRESH AIR SUPPLY



NOTE: The furnace blower must be operated any time the ERV is operated. Use furnace fan "on" continuous low speed or optional FM control to cycle furnace fan on ERV.

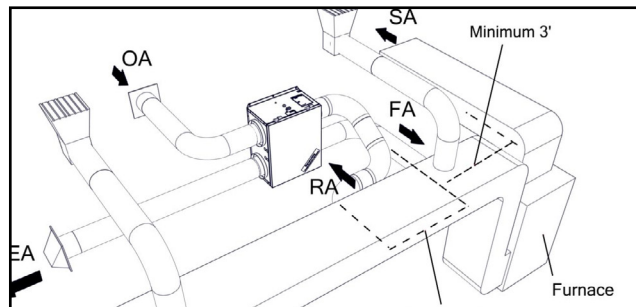

FIGURE 2.4.2 FURNACE RETURN AIR BACK INTO RETURN AIR



NOTE: ERV blower may be operated separate from furnace blower.

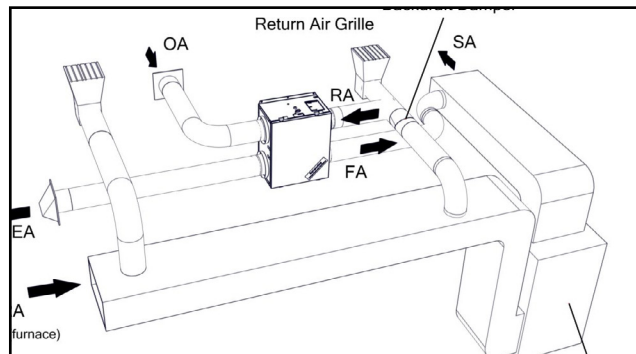

FIGURE 2.4.3 FURNACE RETURN AIR BACK INTO SUPPLY AIR, EV90/P ONLY

## 3.0 INSTALLATION

### 3.1 MOUNTING THE UNIT

- **UNIT MAY BE INSTALLED IN ANY ORIENTATION**

Orient the unit for the simplest duct layout and connections.

- **MOUNT THE EV90/P ON A CONCRETE FOUNDATION WALL**

Mount hanging bracket to the wall with appropriate concrete anchors. Use pre-cut foam tape from small parts bag. Remove backing and apply two pieces of foam tape equally spaced along the unit's mounting flange to be held by the hanging bracket. Apply the other two pieces of foam over two holes that will be used for fastening, on the other flange. The tape should be applied in a "U" shape to cushion both the front and back of the integral flanges. Lift unit and slide unit flange into the hanging bracket. Using metal flat washers, fasten flange opposite hanging bracket to structure. Safety screws should similarly be installed passing through the hanging bracket and flange. Make sure the screws, which you must supply, are properly selected for the loads and substrate involved.

- **MOUNTING THE EV90/P TO A STUD WALL**

Mount unit using supplied hanging bracket kit as described for mounting to concrete foundation wall.

- **SUSPENDING THE EV90/P FROM FLOOR JOISTS OR TRUSSES**

The unit may be screwed directly to joists or trusses using the hanging bracket and integral flange. Mount as described for mounting to concrete foundation wall.

- **MOUNTING THE GR90**

The GR90 can be mounted similar to the EV90 however, the GR90 does not come with a hanging bracket. Using flat washers provided, install screws through the holes in the flanges of the unit. Make sure the screws, which you must supply, are properly selected for the loads and substrate involved.



**NOTE:** The door is equipped with slide-off hinges.

For the homeowner's convenience it is helpful to orient the unit so that the door does not drop off when it is unlatched.



**NOTE:** The hole layout on the integral mounting

flanges and the hanging bracket are spaced for 16" on-center framing patterns.



**NOTE:** The hole layout on the hanging bracket is spaced for 16" on-center layouts.

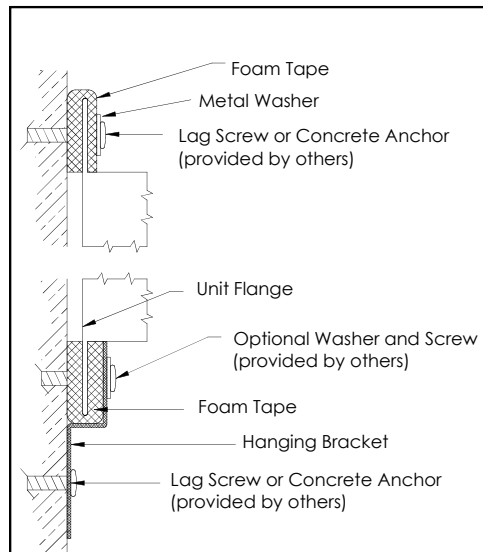

FIGURE 3.1.0 MOUNTING THE ERV TO A STUD WALL, EV90/P ONLY

### ⚠ CAUTION

Risk of injury when lifting unit and installing it overhead. Get a helper and wear eye protection.



**NOTE:** Disconnection means: Most electrical codes require that the unit be disconnected for service. Depending on local codes, an electrical outlet (for EV90/P) or an on/off switch available for the unit (GR90) may satisfy this requirement.

### ⚠ CAUTION

The vapor barrier should be continuous and sealed against air and moisture leakage! If not, condensation or ice may form in cold weather on the duct surface or in its insulation.

### ⚠ CAUTION

Do not place any stale air returns in garages.

### ⚠ CAUTION

Do not connect Dryers to unit. Do not connect Range Hoods to the unit.



**NOTE:** Seal all duct collars a unit to minimize air leakage.

## 3.2 ELECTRICAL CONNECTIONS

Power supply connection to GR90 is made in its electrical box through the hole in the end pan. Pull out the unit electrical box and connect the power wire conductors to the terminal block inside the electrical box. The terminal block inside the electrical box is conveniently marked for connection of field power wiring. After connecting the power wire conductors to the terminal block re-install the electrical box in the unit.

RenewAire offers the EV90/P with a line cord for connection to an electrical outlet. If an EV90/P with a line cord is installed and the installer desires to convert to field power wiring, should local codes permit, simply remove the line cord from the terminal block and connect field wiring as described above.

## 3.3 INSTALLING OUTSIDE AIR AND EXHAUST AIR DUCTS

Ducts connecting the unit to the outside must be well-insulated. Vapor barrier is required on both inside and outside of the insulation.

Band or tape inner duct liner to inner flange of appropriate collar. Drive a sheet metal screw through liner to secure duct spiral wire to collar. Straighten insulation, and slide outer duct jacket onto the outer flange of the duct collar. Secure with band or tape.

The inlets and outlets should be screened against insects and vermin and shielded from the weather to prevent the entry of rain or snow.

## 3.4 INSTALLING RETURN AIR DUCTS

All the stale air returns are connected by ducts to the unit. Generally, empty stud cavities are used for returns as is often done with cold air returns for the furnace, using standard duct boots to connect to six inch pipe at the bottom or top of the wall cavity. Always be sure to seal all joints with duct sealant or tape. Some local codes may require metal ducting all the way from the boots to the stale air grilles. Use rigid ducts to allow the air to move freely and easily through the ducts. See chart under Exhaust and Outside Air Ducts to size your ductwork.

If duct runs are very long (over 30' of flex duct for 90 CFM) or have excessive bends or elbows or if maximum air flow rates are required, eight inch insulated flexible duct should be used. The outer flange of the duct collar can be used for both the inner and outer jacket of the flexible duct. Care must be taken to ensure that the duct is securely fastened and sealed to the duct collar.

### DO NOT USE MORE FLEX DUCT THAN NECESSARY!

Flex duct is much more resistant to airflow than rigid duct; longer runs of flex duct will reduce the ventilation performance of your system. Stretch flex duct and avoid sharp bends.

### ⚠ CAUTION

Install Fresh Air Inlet Away From Sources of Contaminants.

- Do not locate the fresh air inlet where vehicles may be serviced or left idling.
- The fresh air inlet should be at least 10' away from any exhaust such as dryer vents, chimneys, furnace and water heater exhausts, or other sources of contamination or carbon monoxide.
- Install 12" above ground level.
- Never locate the fresh air inlet inside a structure.

### 3.5 CONTROLS

For an installation in which the ERV should run continuously in order to provide the required ventilation rate for the home, no controls are needed. However, in most installations, control over the unit operation is desired and this is best provided by an optional RenewAire Percentage Timer Control (PTL or FM).

Percentage timers (PTL or FM controls for EV90/P or line voltage controls for GR90) may be located anywhere that is convenient. A typical location for either control is next to the home's thermostat. Percentage timers operate the ERV to provide regular background ventilation of the home.

EV90/P installations that pull stale air from specific rooms, such as bathrooms, should have optional RenewAire Push-button Lighted (PBL) Controls in those rooms. The secondary operating controls allow the system to be turned on from various locations in the house.

#### ⚠ WARNING

DANGER OF ELECTRICAL SHOCK WHEN SERVICING AN INSTALLED UNIT.

Always unplug unit before connecting or servicing controls.

#### 3.5.1 Installing Controls

The EV90/P is offered with a control board for connection to external controls. The GR90 runs continuously whenever power is supplied to it.

- **Optional Controls:**  
RenewAire offers a variety of controls specifically designed to work with the EV90/P. These include: PTL (a two wire percentage timer), FM (a six wire percentage timer that will interconnect with the furnace blower), and PBL (point of use push button control). Other controls that throw an unpowered switch may also be used.

The GR90 is a line voltage unit that may be controlled with any line voltage control switch.

- **Typical Control Schematic:**  
Various wiring designs can be used to properly control the unit and meet safety and code concerns. Consult your electrician for an electrical design to meet your needs.

The schematic below (Figure 3.5.0) shows a typical control system: a PTL percentage timer plus two PBL push-button controls.

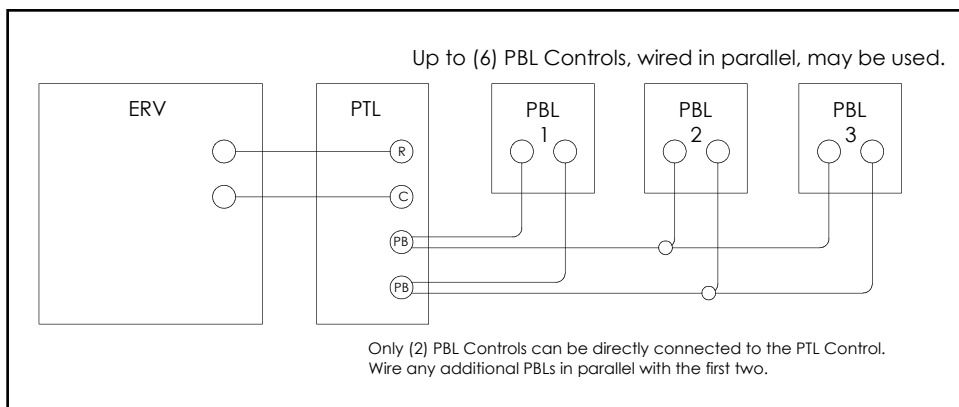

FIGURE 3.5.0 TYPICAL CONTROL SCHEMATIC, EV90/P ONLY

See installation manuals for the control(s) you select for wiring diagrams and specific instructions.

- If **NOT** connecting controls to the EV90/P:  
Make a jumper out of a short piece of wire. Connect the jumper wire to the screw connections of the terminal strip on the outside of the unit. ERV runs full-time once its power cord is plugged in.

## 4.0 OPERATION

### 4.1 STARTING UP THE UNIT

- Inspect your installation to be sure all duct work is correctly installed and sealed, that filters are in place, and controls (if any) are connected.
- Shut and latch the door to the unit.
- Provide 115 VAC to the unit. It may start immediately.
- Use control if any, to turn on the unit. Check operation of the control(s).
- Check that the unit's safety interlock switch turns off the unit when the door is opened.

### 4.2 VERIFYING UNIT PERFORMANCE

#### 4.2.1 Airflow

Airflow should be occurring in both airstreams. Sometimes the easiest place to confirm that air is moving is at the external wall caps. If exact airflow is critical, it may be desirable to permanently install flow measuring stations and manometers. These can also be used to determine when filters should be cleaned or changed.

#### 4.2.2 Use Static Taps to Measure Airflow Rates

See Differential Static Across Core tables in Section 4.4 on page 19.

#### 4.2.3 Use Damper to Balance Airflow to Desired Rates, if necessary

The ERV's blower motors are well suited for volume control by dampers on the inlet of the unit. One balancing damper is provided in the unit parts tray.

After measuring the airflow of the unit, the balanced damper may be used to balance airflow if desired. Place the damper between the duct collar and the unit for the inlet of the airstream recording higher flow.

Slowly move the damper further into the duct until the desired airflow is recorded. Secure the damper in place using 1/8" tek screws (provided).

 **NOTE:** The unit is considered balanced if the difference between the two airflows is not more than 10 CFM.

 **NOTE:** Install the damper so that it slides in the space between the duct collars for the EV90 and the GR90. Install the damper so that it slides from the door of the unit down to the duct collar for the EV90P.

 **NOTE:** Drilling through the case while the unit is running may cause metal shards to be drawn into the unit.

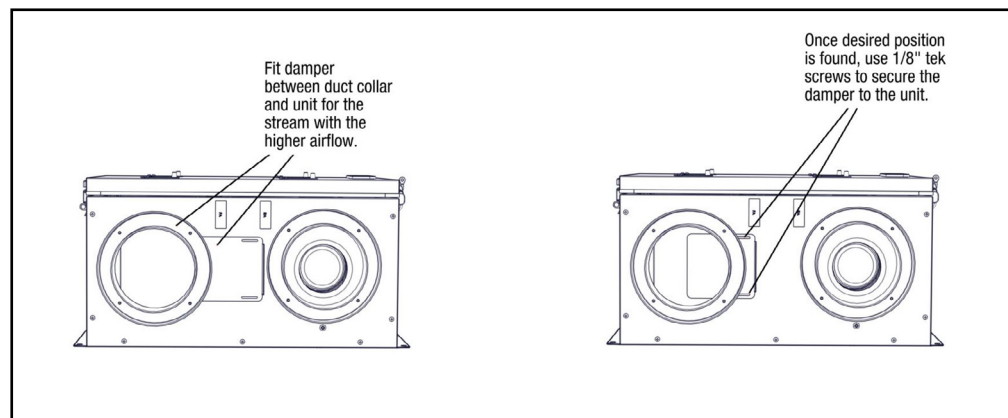

FIGURE 4.2.0 DAMPER INSTALLATION

### 4.3 MEASURING AIRFLOW

#### 4.3.1 Equipment Required

- A magnehelic gauge or other device capable of measuring 0–1.0 in. water of differential pressure.
- 2 pieces of natural rubber latex tubing, 1/8" ID, 1/16" Wall works the best.

### 4.4 MEASURING CROSS CORE STATIC PRESSURE

The individual differential static pressures (DP) are measured using the installed pressure ports located in the front of the units core access doors.

Do not relocate pressure ports.

- To read SCFM of Fresh Air (FA) install the “high” pressure side (+) of your measuring device to the Outside Air (OA) port and the “low” pressure side (-) to the Fresh Air (FA) port.
- To read SCFM of Room Air (RA) install the “high” pressure side (+) of your measuring device to the Room Air (RA) port and the “low” pressure side (-) to the Exhaust Air (EA) port.
- If gauge drops below zero, reverse tubing connections.
- Use the reading displayed on your measurement device to cross reference the CFM output using the conversion chart.

#### **CAUTION**

Make sure clean filters are installed before balancing airflow. Dirty or clogged filters reduce airflow through the unit.

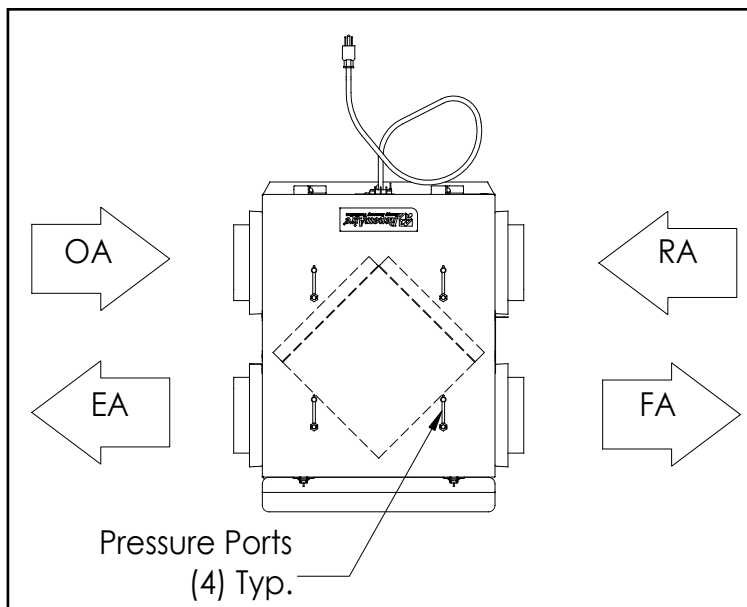

FIGURE 4.4.0 AIRFLOW DIAGRAM EV90/P



**NOTE:** Be sure to remove cap from pressure port before inserting tubing. In-sure tubing is well seated in pressure ports.



**NOTE:** The tubing should extend in the pressure port approx. 1".



**NOTE:** These ports are carefully located on the unit to give the most accurate airflow measurement.



**NOTE:** Be sure to replace cap into pressure port when airflow measuring is completed.



**NOTE:** For best performance the airflow rate for both the Fresh Air and the Exhaust Air should be roughly equal (“balanced”). In some facilities a slight positive or negative pressure in the building is desired. RenewAire ERVs can generally operate with a flow imbalance of up to 20% without significant loss in energy recovery efficiency.

### ⚠ CAUTION

Make sure clean filters are installed before balancing air flow. Dirty or clogged filters reduce airflow through the unit.

### ⚠ CAUTION

The proper airflow range for the models are 40-110 CFM.

### ⚠ WARNING

Risk of Fire, Electric Shock, or Injury.

- Before servicing or cleaning the unit, unplug the line cord.
- Make sure unit is not running before opening its door. Blower wheels are sharp and can cut.
- Do not disable the interlock switch: it is there for your safety.

### ⚠ CAUTION

**DO NOT WASH THE ENERGY EXCHANGE CORE.**

Keep it away from water or fire to avoid damaging it. Always handle the core carefully.



**NOTE:** The filters should be replaced after they have been cleaned several times.



**NOTE:** Filters must be used or the face of the energy exchange core will become blocked by dust and reduce unit efficacy. The filters supplied in the unit are usually able to keep the energy exchange core clean for many months. Finer filters can be used but must be cleaned more often.

#### DIFFERENTIAL STATIC ACROSS CORE DSP VS. CFM

EV90, GR90		DSP	0.10	0.20	0.30
	Fresh Air (FA)	CFM	42	84	127
	Room Air (RA)	CFM	42	84	127

#### DIFFERENTIAL STATIC ACROSS CORE DSP VS. CFM

EV90P		DSP	0.10	0.20	0.30
	Fresh Air (FA)	CFM	58	115	173
	Room Air (RA)	CFM	58	115	173

## 5.0 MAINTENANCE

Keep your ERV performing at its best by cleaning it as described below.

### 5.1 TO CLEAN THE ENERGY EXCHANGE ELEMENT

1. Remove the filters (see below).
2. Vacuum the exposed faces of the energy exchange core with a soft brush attachment.
3. After servicing the filters, re-install them (see below).
4. Vacuum out dust from the rest of the unit case. Dust collects only on the entering faces of the energy exchange core. The interior of the energy exchange core stays clean even if the core faces are dust covered. The core flutes move the air in a laminar airflow such that particulate deposition is maintained at virtually nil.

### 5.2 INSPECT AND CHANGE THE FILTERS REGULARLY

Service filters every three months when the unit is in regular use or as needed to keep them reasonably clean.

1. Release cam latches and carefully swing access door open. Remove the door by sliding to one side.
2. Remove filter clips.
3. Pull the filters out.
4. Vacuum with a hose attachment.
5. Re-install filters and filter clips, see Section 5.5 Service Parts. Orange side of filter should face the core.
6. Re-install door, and fasten cam latches.

The primary contact for replacement filters for your RenewAire unit is the installing contractor. As an alternative, you may wish to produce your own filters. Please follow these instructions:

Filters may be cut from a sheet or roll of ¾"–1" firm, spun polyester filter "hog hair" media or material, similar to the existing filter in the residential unit.

The size of each filter (2 required per unit) is as follows:

**EV90/GR90** 9 ½" x 10 ½"

**EV90P** 21 ¾" x 10 ½"

Call your HVAC contractor or RenewAire for further information.

### 5.3 MOTOR MAINTENANCE

The blower/motor package needs no lubrication:

Vacuum clean the blower wheels at the same time you clean the face of the energy exchange core. Confirm blower wheel is not rubbing against the blower inlet or housing by rotating wheel manually.

### 5.4 GENERAL CLEANING AND INSPECTION

Perform general cleaning and visual inspection when changing filters.

1. Remove paper, leaves, etc. from inlet and outlet screens.
2. Inspect for insect nests.

### 5.5 SERVICE PARTS

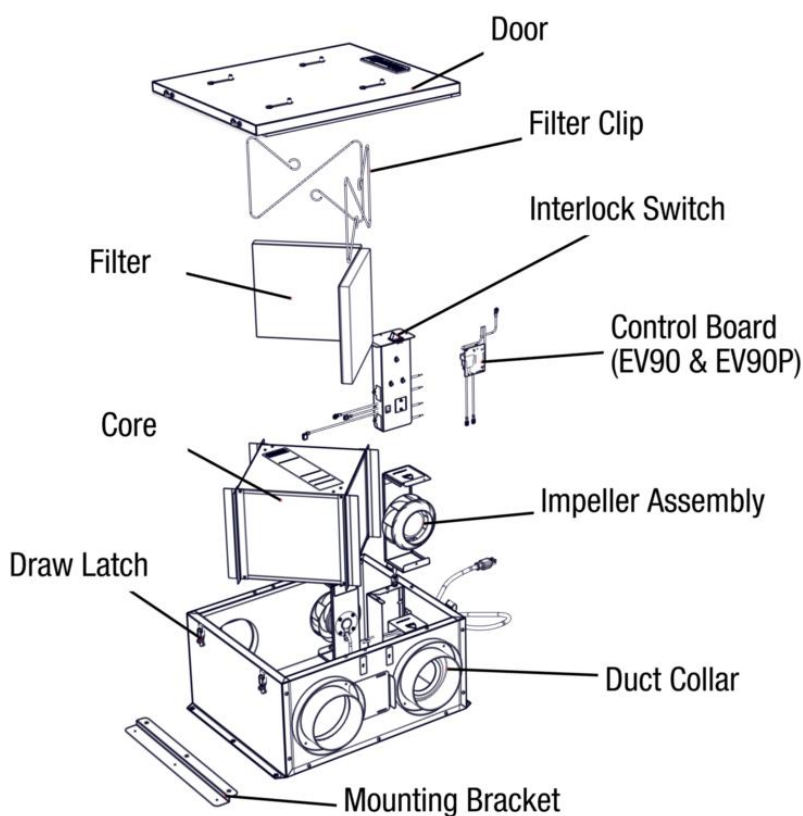

FIGURE 5.5.0 SERVICE PARTS, EV90/P

## 6.0 FACTORY ASSISTANCE

In the unlikely event that you need assistance from the factory for a specific issue, make sure that you have the information called for in the Unit Information page in the front of this manual. The person you speak with at the factory will need that information to properly identify the unit.

To contact RenewAire Customer Service:

Call 800-627-4499

Email: [RenewAireSupport@RenewAire.com](mailto:RenewAireSupport@RenewAire.com)



## About RenewAire

For over 30 years, **RenewAire** has been a pioneer in enhancing indoor air quality (IAQ) in commercial and residential buildings of every size. This is achieved while maximizing sustainability through our fifth-generation, static-plate, enthalpic-core **Energy Recovery Ventilators (ERVs)** that optimize energy efficiency, lower capital costs via load reduction and decrease operational expenses by minimizing equipment needs, resulting in significant energy savings. Our ERVs are competitively priced, simple to install, easy to use and maintain and have a quick payback. They also enjoy the industry's best warranty with the lowest claims due to long-term reliability derived from innovative design practices, expert workmanship and **Quick Response Manufacturing (QRM)**.

As the pioneer of static-plate core technology in North America, RenewAire is the largest ERV producer in the USA. We're **committed to sustainable manufacturing** and lessening our environmental footprint, and to that end our Waunakee, WI plant is 100% powered by wind turbines. The facility is also one of the few buildings worldwide to be LEED and Green Globes certified, as well as having achieved ENERGY STAR Building status. In 2010, RenewAire joined the Soler & Palau (S&P) Ventilation Group in order to provide direct access to the latest in energy-efficient air-moving technologies. For more information, visit: [renewaire.com](http://renewaire.com)

201 Raemisch Road | Waunakee, WI | 53597 | 800.627.4499 | [RenewAire.com](http://RenewAire.com)